

2017
Celebrate the 47th Annual

Holiday ARTS & CRAFTS SALE Bazaar

Presented by the RMSC Women's Council:

Friday, Nov. 17: 5–9pm | Saturday, Nov. 18: 9:30am–5pm | Sunday, Nov. 19: 11am–4pm

2017 GUIDE TO EXHIBITORS

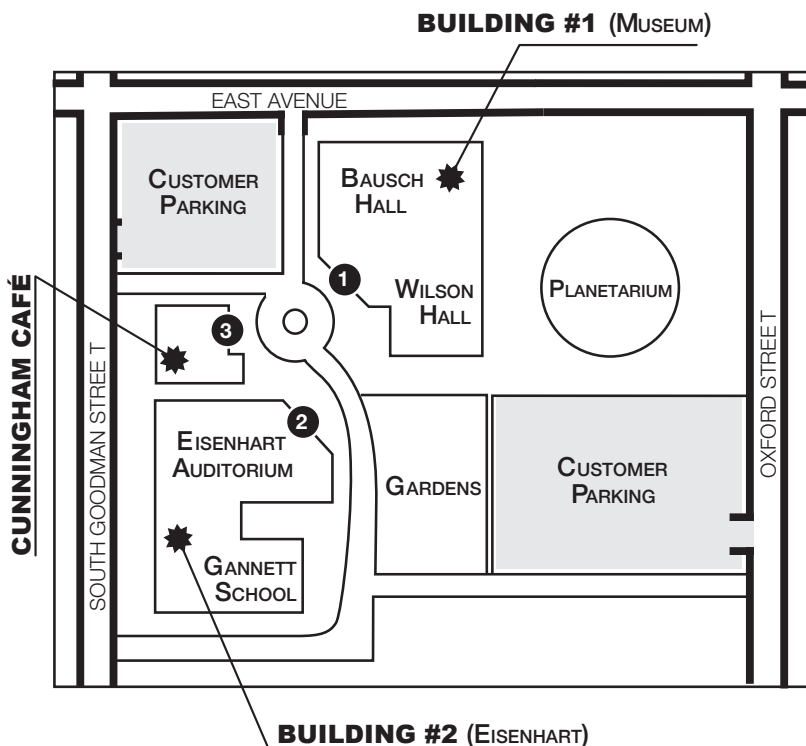

Look for Women's Council hostesses wearing red aprons who will be circulating in all areas to answer any questions and give directions.

Women's Council
RMSC
Rochester Museum & Science Center

Affaire de Chocolate	Chocolate Candies	161
Bubba Bow Wow	Dog Clothing	162
Neil Barman & Nicole Winrock	Ceramics	112
Deb Benedetto	Pottery	171
Richard Birkett	Fantasy Clocks	122
Ann Borelli	Purses	121
Ann Campbell	Handpainted Items	114
Mary Carlic	Bath & Body Products	134
Sandy & Dale Chatterton	Hand Painted Switch Plates	100
Jennifer Greatbatch	Pet Treats	115
Patricia Coleman	Stained Glass	113
Mark Corwin	Ceramics & Digital Collage	104
Julius Dorsey	Wooden Lamps and Mirrors	128
Karen Ferner	Recycled Textile Clothing	130
Marissa Gallelli & Cheryl Cenzi	Sculpture/Fine Art	125
Bernice Goodell & Gee Gerlock	Felted Textiles	101
Chelsea & Jeremy Griffith	Handblown Glass	108
Pat Halpen	Leather Bags & Accessories	102
Heather Lynn Harris	Fine Art	120
Velta Karlsons-Huck	Fine Jewelry	137
Stephanie Jane	Mixed Media	110
Mary Jean Lambiase & Ann Langkopf	Fiber Art	105
Linda Lawrence	Glass Bead Jewelry	109
Barbara Mason	Decorative Painting	160
Antoinette & Dan McClure	Enamel Jewelry	136
Michael Mole	Candy Apples & Candy	127
Paula Moore	ReCreations Jewelry	169
Pam Nakoski	Vintage Inspired Jewelry	166
Brenda Olshan	Felted & Knitted Items	135
Otto E. Orf	Hardwood Baskets	106
Kim Paige	Nature Themed Jewelry	129
Heather Patterson	Sterling Silver Jewelry	173
Vadim Pavliouk	Glass Figures & Sculptures	133

Gail G. Peterson	Knitted Items	168
James Pullman	Painting	138
Mary Reynolds	Fine Arts	123
Judy & Chris Rohrbaugh	Stoneware Pottery	124
Mary Ann Sawyer-Wade	Paintings & Notecards	111
Lisa Schneider	Glass Windchimes	126
James Schrader	Woodworking	163, 164
Lisa Jane Smith	Illustrations	172
Melanie Steenhoff	Felted Textiles	174
Mary Terziani	Serving Pieces	165
Angela Tiberio	Herbal Items	139
Laura Wilder	Fine Art Prints	118
Lynda F. Wildman	Crochet & Knitted Clothing	117

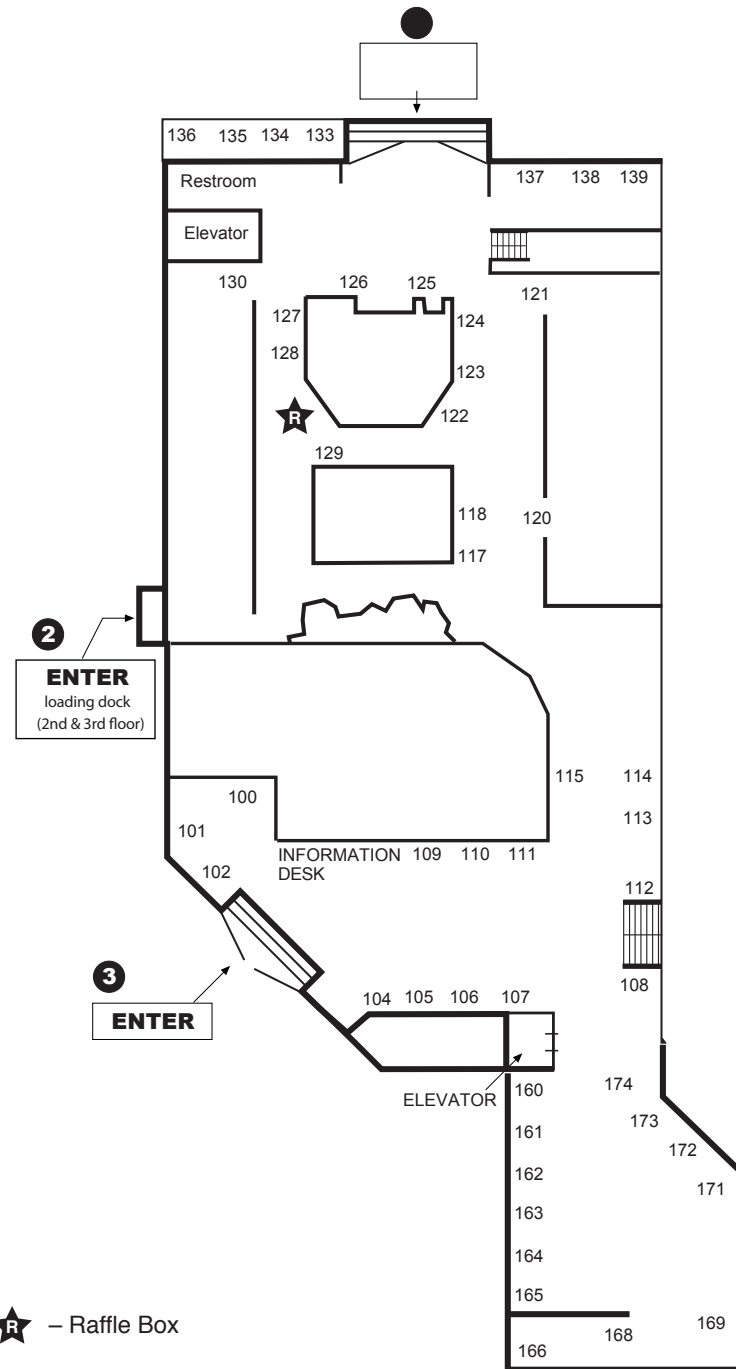

★ – Raffle Box

Building #1—Mezzanine

Rebecca Barry-Kent	Jewelry & Art Dolls	624
Heather Behrendt	Jewelry	614
Bill & Christin Bentley	Wood & Ceramics	618
JoAnne & Steve Billings	Steampunk Lamps	611
Jorien Brock	Enamel Jewelry	620
Denis & Judy Caysinger	Wooden Items	608
Sage Churchill Foster	Functional Glass	617
Kathy Cretelle	Vintage Inspired Jewelry	619
Kathleen Daniele	Home Decor	616
Abby Dening	Illustrations	606
Carol Domenico	Painted Silk	612
Fallon Dumais	Bath & Body Products	613
Cynthia Evans	Tea	621

Carlie Evans	Photography	623
Rick & Liz Fickhesen	Organic Spice Blends	622
Marty Guenther	Photography	605
Susan Peterson	Art Books	626
Elleen & Michael Radigan	Fused Glass	609
Matt Rogers	Rochester Design T-Shirts	615
Maria Victoria Savka	Printmaking	625
Ruthann Stilwell	Quilted Items	610
Margaret Supinski	Original Beaded Jewelry	607

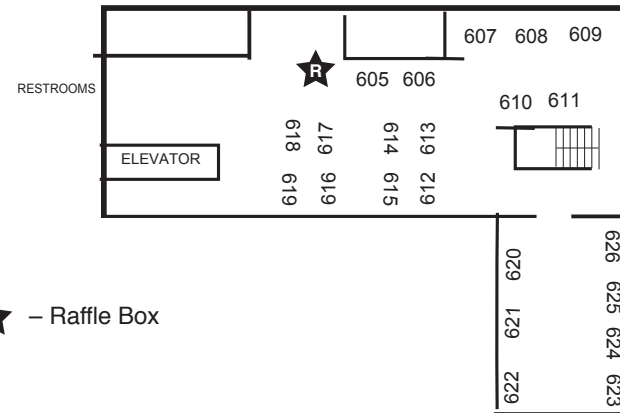

Building #1—Second Floor

Jason Ackerman	Photography	206
Elizabeth Andrews	Printmaking	213
Joanne Andrews	Watercolor	218
	Paintings & Flags	
Janice Baylis	Handcrafted Jewelry	211
Jen & Dave Beadling	Painted Glass & Photography	205
Richie Bittner	Widflower Tiles, Prints, Cards	252
Carol Ann Bosek	Handcrafted Jewelry	222
Vicki Brouk	Block Printed Clothing	264
Mary Catherman	Fused Art Glass	223
Claudia Chandler	Baskets, Textiles, Jewelry	250
Christine Coffey	Handpainted Silk	207
Rachel Cordaro	Paintings & Textiles	214
Cordell Cordaro	Paintings & Prints	215
Penny Despos	Wire & Beaded Jewelry	231
Mark Detrick	Wooden Items	212
Chara Dow	Wood	254
Joan DuRocher	Children's Clothing	224
Hillary Dzina & Krystyna Gasiewski-Wojcik	Book Art	265
Mary Ensmann	Icons and Cards	216
Celeste Friend	Sterling Silver Jewelry	219
Deborah Gamham	Gourmet Popcorn	203
Michael Gotthelf	Wooden Items	251
Irene Grassmann	Ukrainian Beading & Eggs	240
Betty Green	Pressed Flowers	263
Leigh Hannan	Mixed Media Art	209
Sara Hickman-Himes	Cards & Prints	234
Alexius & Don Jones	Glass	247
Nella Joseph	Handpainted Glassware	249
Jackie Kukurudza	Jams & Jellies	239

Hobit Lafaye	Photography	255
Marcia Lewis	Travel Textiles	227
Rebecca Lomuto	Etching & Photography	244
Lisa Maffiore	Fine Jewelry	228
LeAnne Marquis	Mixed Metal Jewelry	204
Rie Maywar	Japanese Washi Art	238
Susan Mehringer	Hardweaving & Knitted Items	248
Debbie Mertisky & Mark Rotman	Mixed Media	261
Tori DiPietro Motyl	Ceramics	202
Cory O'Rourke	Iron Sculptures & Houseware	253
Chris Pallace & Kevin Serwacki	Fairy Doors	236
Wendy Pound	Pebble Portraits	233
Jill Schiller	Geometric Designs	260
Donna Schneider	Chocolate Candies	225
CJ Segal-Jsaacson	Jewelry	230
Victor Silva	Fine Jewelry	241
Susan Snook	Ceramics	221
Jim Spina	Framed Punched Tin Artwork	232
Carla Staples	Wood Jewelry	262
Claire Sutura	Leather Purses	243
Stefani Tadio	Paper Crafts	220
Julia Tan	Jewelry	226
Kate Thompson	Paper Art & Calligraphy	217
Kelly Thompson-Waltdt	Fine Jewelry	201
Lisa Twombly	Artisan Jewelry	245
Erin Unz	Hair Accessories	246
Jessie Valone	Ceramics	235
Erica Wilson	Mixed Media	229
Gail G. Worboys	Stained Glass	208

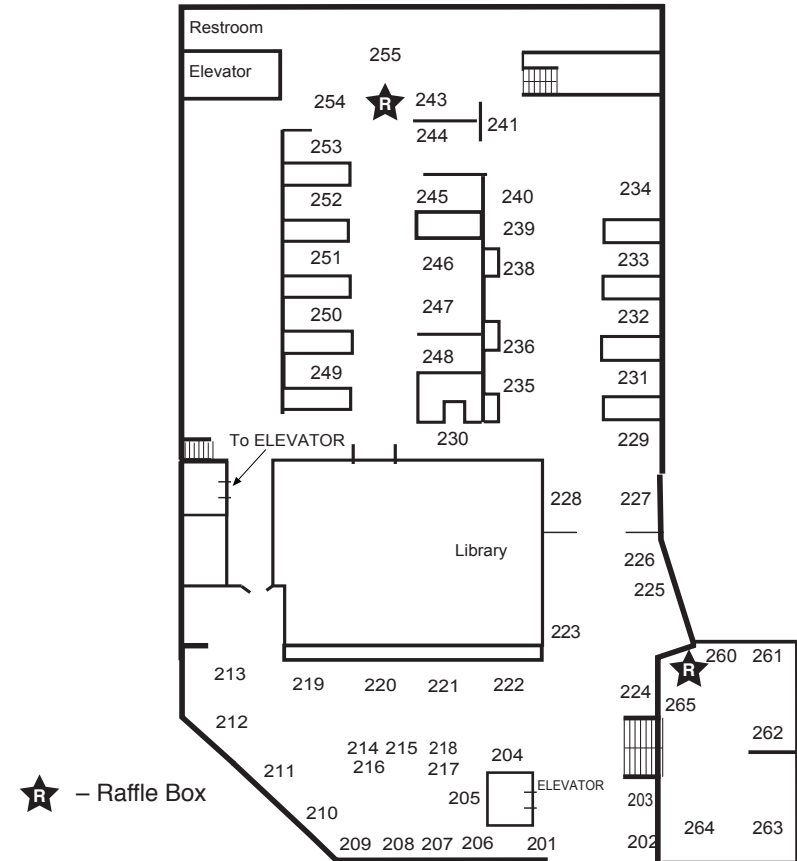

Building #1—Second Floor

Building #1—Third Floor

Mary Blanchard	Jewelry	324
Charley & Sue Blum	Gourmet Food	325
Louise Cardillo	Scarves from Saris	333
Nils Caspersson	Scandinavian Themed Art	332
Linda Connir Cass	Jewelry	326
D. Leah Corey	Beadwork Jewelry	302
Denise Duellman	Mitten Art	303
LB Falk	Fused Glass	322
Chris Goodenbury	Photography	320
Jessica Goodenbury	Jewelry	321
Anne Marie Maier	Photography	310
Betty McNeil	Pressed Flowers	316
Juana Morreale	Handmade Purses	306
Betsy Murray	Jewelry	304
Charles Peashey	Repurposed Musical Instruments	300
Lori Prince	Jewelry	317
Jamie Redmond	Photography	305
Janice Reif	Quilts	330
Jodi Revill	Candy & Cookies	301

Donna Richardson	Ukrainian Eggs	312
Cheryl Robbins-Dooley	Artisan Chocolates	311
Holly Ruby	Fused Glass Jewelry	308
Kimberly Siegfried	Dried Floral Jewelry	315
Neville & Margurette Sinclair	Lavendar Products	334
Christi Sobel	Illustrations	314
Laurie Turner	Pottery	327
Karlene VanDusen	Landscape Painting	329
Hayna Weems	Body Lotions	328
Casey Wright	Felted Animals	307

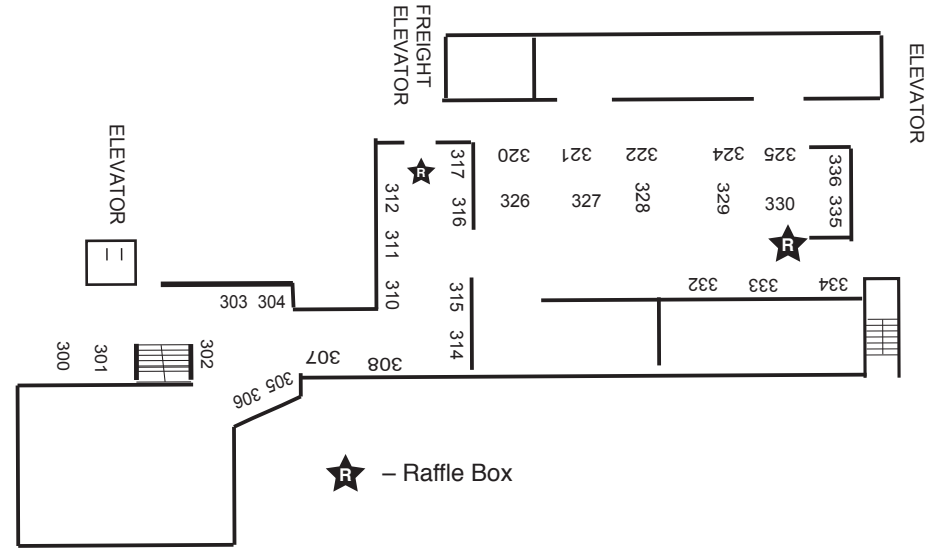

Building #2

Megan Alchowiak	Quilled Art	408
Kaaren Anderson	Animal Plates	521
Catherine Ayers	Handblown Glass	524
Terri Barbero	Wood Jewelry & Wood	537
Jennifer Born	Mixed Media	523
Meredith Butler	Box Maker	529
Cherie Carter	Textiles	517
Kristen Curley	Mosaics	536
Kim Doty	Candy, Jam & Soap	507
Elizabeth Durand	Original Etchings & Prints	503
Carmen Gumina	Jewelry	406
Laura Harford	Soap & Accessories	518
Robert Henry	Fine Art	522
Sharon Hughto	Photography	504
Earl Jacobson	Paintings & Pillows	403
Earl Jacobson	Stoneware Pottery	527
Lisa Johnson	Jewelry	532
Lisa Lelio	Greeting Cards	516
Carrie Lindstrom	Paintings & Illustrations	506
Carol Lurz	Textiles, Purses	502
Susan O'Brien	Jewelry	400
Anna Overmoyer	Sculpture/Fine Arts	504
Bridget Paddock	Illustrations	513
Joan V. Parker	Beadwork Jewelry	511

Margaret Parker	Mittens & Hats	534
Pam Pratt & Peggy Foust	Felted Items	520
Colette Savage	Pastel Paintings	514
Daniel Schmidt	Stained Glass	407
Patricia Schmitt	Floral Arrangements, Wreaths	505
Anita Sinsigalli	Aprons	531
Mary Elizabeth Skillings	Basketry	512
Pamela Storms	Ceramics & Ceramic Jewelry	501
Robin Strauss	Glass Artist	402
Jesse Szalc	Wood	528
Amelia Templar	Knit & Crochet	535
Karen Tretiak	Jewelry	519
Amy VanPatten-Begy	Children's Items	404
Karin Wallin	Painting	538
Charles Willard	Wood Turnings	405
Rebecca Wind	Ceramics	401

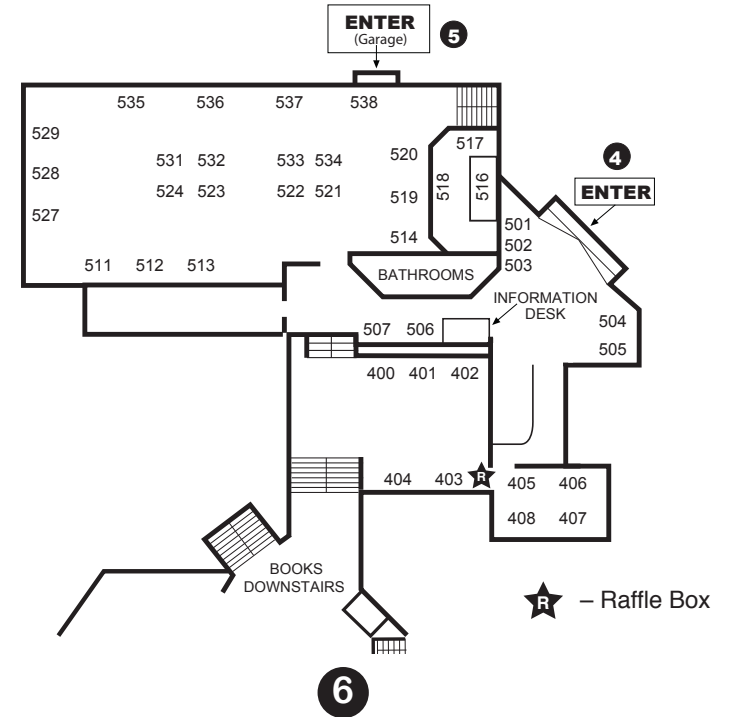

5

6

The Women's Council gratefully thanks the following sponsors for their support of the 2017 Holiday Bazaar Arts & Crafts Sale:

Peerless Events

3rd ROC Café

Nolan's Rental

Thank you to the following businesses for donating prizes to our raffles

Applebee's Neighborhood Grill

Atlantic Family Restaurant

DiBella's Old Fashioned Submarines

Jines Restaurant

Kittelberger Florist & Gifts

Mark's Pizzeria

Olive Garden Italian Restaurant

Parkside Diner

Scott Miller Salon & Spa

Shamrock Jack's

Visit the Cunningham Café in Building 3 for great food and beverages.

The Regency style dwelling, which is home to the RMSC's administrative offices, was originally constructed in 1880 and purchased by the Cunninghams in 1916. A wing was added to the house to serve as Mrs. Cunningham's studio—as she was a professional artist and patron of the arts. It is fitting that the studio doors be open to visitors during the three-day art event at the Museum.

Happy Holidays!

Thank you for your support!

All proceeds from the Holiday Bazaar directly support the Rochester Museum & Science Center.



RMSC Membership make wonderful gifts!